



# MOLETEADORES POR DEFORMACIÓN FORM-KNURLING TOOLS



## M10

### + Características

- Recomendado para moleteados tipo RAA
- Para moleteados hasta una cara lateral (Fig. 1)
- Eje de HSS
- Para trabajar a derechas o izquierdas (Fig. 2)
- Superficie endurecida para una mayor resistencia al desgaste
- Ajuste del ángulo de ataque mediante tornillos integrados en el mango
- Provista de arandela de HSS para prevenir el desgaste de la herramienta

### + Features

- Recommended for RAA type knurling
- For knurling up to a shoulder (Fig. 1)
- HSS bushing
- Able to fit on right-hand or left-hand (Fig. 2)
- Anti-wearing treatment of the tool surface
- Adjustment of tool clearance angle by threaded studs integrated in the shank
- Supplied with a HSS hardened washer to prevent tool wearing

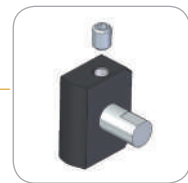

(Fig. 1)

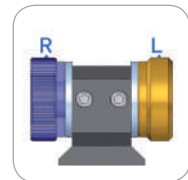

(Fig. 2)

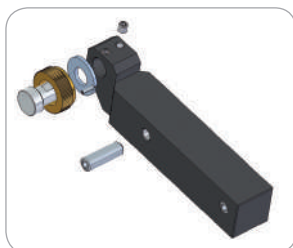

### + Avance Feed

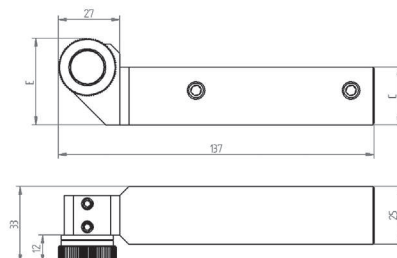
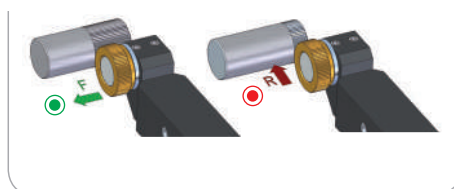

### + Formas de moleteados realizables Feasible knurling forms

|                                     | <b>R</b> | RAA     | RBL 30° | RBL 45° | RBR 30° | RBR 45° | RGE 30° | RGE 45° | RGV 30° | RGV 45° | RKE | RKV |
|-------------------------------------|----------|---------|---------|---------|---------|---------|---------|---------|---------|---------|-----|-----|
| Tipo de moleteado<br>Knurling form  |          |         |         |         |         |         |         |         |         |         |     |     |
| Con moleta tipo<br>With knurl type  |          | AA      | BR 30°  | BR 45°  | BL 30°  | BL 45°  | GV 30°  | GV 45°  | GE 30°  | GE 45°  | KV  | KE  |
| Avances permitidos<br>Allowed feeds |          | F ● R ● | F ● R ● | F ● R ● | F ● R ● | F ● R ● | R ●     | R ●     | R ●     | R ●     | R ● | R ● |

**R** Moleteados recomendados | Recommended knurling

| Herramienta   Tool |                         |                    |                       |                 |    |    |     |
|--------------------|-------------------------|--------------------|-----------------------|-----------------|----|----|-----|
| Código<br>Code     | Referencia<br>Reference | Versión<br>Version | Capacidad<br>Capacity | Moleta<br>Knurl | C  | E  | Kg  |
| 01070100           | M10 25.10.20            | R+L                | ∅ 8-200               | 25x10x15/11     | 20 | 30 | 0.7 |
| 01070200           | M10 25.10.25            | R+L                | ∅ 8-200               | 25x10x15/11     | 25 | 35 | 0.8 |

| Repuesto   Spare Part |                         |
|-----------------------|-------------------------|
| Código<br>Code        | Referencia<br>Reference |
| 01983200              | EAM10                   |

