



MOLETEADORES POR DEFORMACIÓN FORM-KNURLING TOOLS



M15

+ Características

- Recomendado para moleteados tipo RKA
- Para moleteado frontal o cónico
- Cabeza portamoletas giratoria (Fig. 1)
- Eje de metal duro

+ Features

- Recommended for RKA type knurling
- For conical or face knurling
- Swivel tool head (Fig. 1)
- Carbide pin

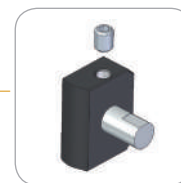

(Fig. 1)

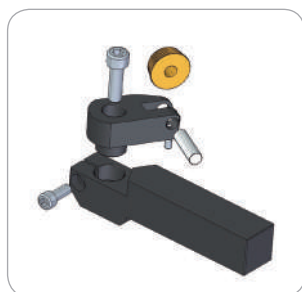

+ Avance Feed

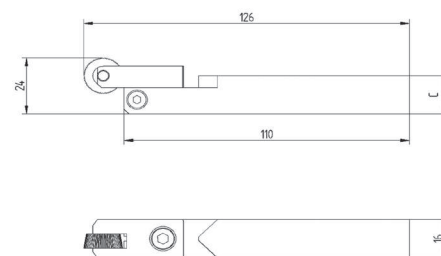

Modelo M15 15

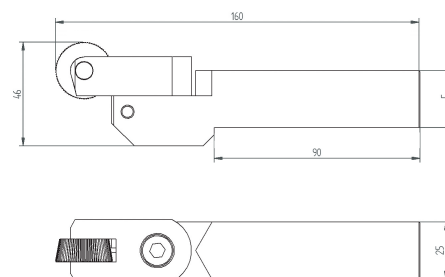

Modelo M15 25

+ Formas de moleteados realizables Feasible knurling forms

	R RKA	R RKBL 30°	R RKBR 30°
Tipo de moleteado Knurling form			
Con moleta tipo With knurl type	KAA	KBR 30°	KBL 30°
Avances permitidos Allowed feeds	R	R	R

R Moleteados recomendados | Recommended knurling

Herramienta Tool						
Código Code	Referencia Reference	Versión Version	Capacidad Capacity	Moleta* Knurl*	C	Kg
01150100	M15 15.06.12	R+L	Ø 3-100	15x6x4 (c nica/conical)	12	0,3
01150200	M15 15.06.16	R+L	Ø 3-100	15x6x4 (c nica/conical)	16	0,3
01150300	M15 25.08.20	R+L	Ø 8-300	25x8x8 (c nica/conical)	20	0,6
01150400	M15 25.08.25	R+L	Ø 8-300	25x8x8 (c nica/conical)	25	0,8
01150500	M15 25.10.20	R+L	Ø 8-300	25x10x8 (c nica/conical)	20	0,6
01150600	M15 25.10.25	R+L	Ø 8-300	25x10x8 (c nica/conical)	25	0,8
01150700	M15 25.12.20	R+L	Ø 8-300	25x12x8 (c nica/conical)	20	0,8
01150800	M15 25.12.25	R+L	Ø 8-300	25x12x8 (c nica/conical)	25	0,8

Repuesto Spare Part	
Código Code	Referencia Reference
01982200	E 16.4 HM
01992500	EM15 25.08 HSS



*Dimensiones aproximadas / Approximate sizes