



MOLETEADORES POR CORTE CUT-KNURLING TOOLS



MF 21 VDI

+ Características

- Recomendado para moleteados tipo RGE
- Ajuste de las moletas segun diámetro a moletear mediante escala graduada (Fig. 2)
- Cabeza basculante para el alineamiento de las moletas (Fig. 1)
- Ejes de HSS+TIN

+ Features

- Recommended for RGE type knurling
- Easy setting to the workpiece diameter by means of a graduated scale (Fig. 2)
- Pivoting head for knurl alignment (Fig. 1)
- HSS+TIN bushing

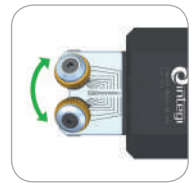

(Fig. 1)

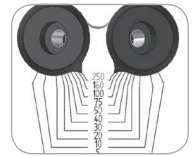

(Fig. 2)

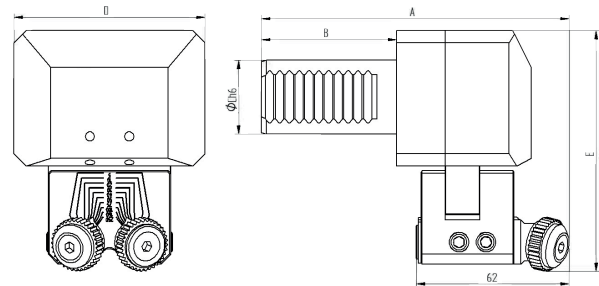
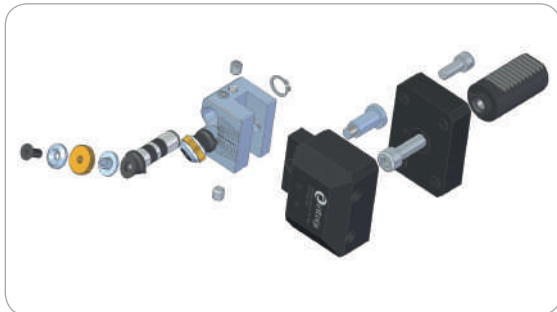

+ Avance Feed

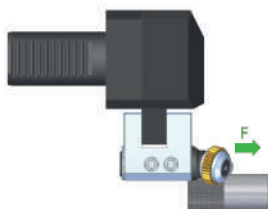

+ Formas de moleteados realizables Feasible knurling forms

	R RGE 30°	R RGE 45°
Tipo de moleteado Knurling form		
Con moleta tipo With knurl type	AA + AA	BL15° + BR15°
Avances permitidos Allowed feeds	F	F

R Moleteados recomendados | Recommended knurling

Herramienta Tool										
Código Code	Referencia Reference	Versión Version	Capacidad Capacity	Moleta Knurl	A	B	C	D	E	Kg Kg
01140100	MF 21.55 VDI 30R	R	Ø 5 ÷ 250	21.5x5x8	126	55	30	68	95	2.6
01140200	MF 21.55 VDI 30L	L	Ø 5 ÷ 250	21.5x5x8	126	55	30	68	95	2.6
01140300	MF 21.55 VDI 40R	R	Ø 5 ÷ 250	21.5x5x8	136	63	40	78	98	2.9
01140400	MF 21.55 VDI 40L	L	Ø 5 ÷ 250	21.5x5x8	136	63	40	78	98	2.9

Repuesto Spare Part		
Código Code	Referencia Reference	
01985700	EAT 21.55	