



MOLETEADORES POR DEFORMACIÓN FORM-KNURLING TOOLS



M20

+ Características

- Recomendado para moleteados tipo RAA
- Para moleteados hasta una cara lateral (Fig.1)
- Eje de HSS
- Superficie endurecida para una mayor resistencia al desgaste
- Ajuste del ángulo de ataque mediante tornillos integrados en el mango

+ Features

- Recommended for RAA type knurling
- For knurling up to a shoulder (Fig.1)
- HSS bushing
- Anti-wearing treatment of the tool surface
- Adjustment of tool clearance angle by threaded studs integrated in the shank

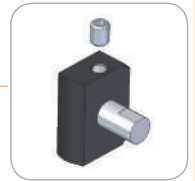

(Fig. 1)

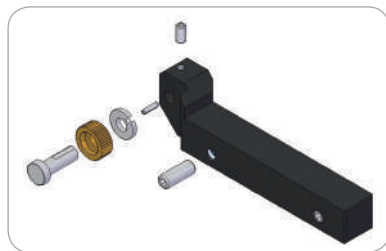

+ Avance Feed

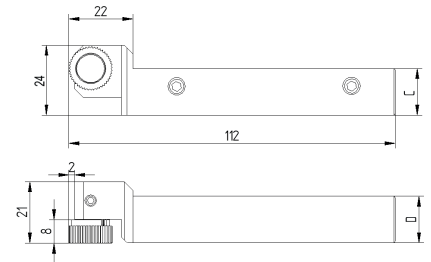
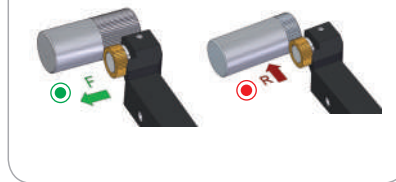

+ Formas de moleteados realizables Feasible knurling forms

	R	RAA	RBL 30°	RBL 45°	RBR 30°	RBR 45°	RGE 30°	RGE 45°	RGV 30°	RGV 45°	RKE	RKV
Tipo de moleteado Knurling form												
Con moleta tipo With knurl type		AA	BR 30°	BR 45°	BL 30°	BL 45°	GV 30°	GV 45°	GE 30°	GE 45°	KV	KE
Avances permitidos Allowed feeds		F ● R ●	F ● R ●	F ● R ●	F ● R ●	F ● R ●	R ●	R ●	R ●	R ●	R ●	R ●

R Moleteados recomendados | Recommended knurling

Herramienta Tool							
Código Code	Referencia Reference	Versión Version	Capacidad Capacity	Moleta Knurl	C	D	Kg
01290300	M20 15.06.10 R	R	∅ 3-100	15x6x10/6	10	10	0.3
01290400	M20 15.06.10 L	L	∅ 3-100	15x6x10/6	10	10	0.3
01290500	M20 15.06.12 R	R	∅ 3-100	15x6x10/6	12	16	0.3
01290600	M20 15.06.12 L	L	∅ 3-100	15x6x10/6	12	16	0.3
01290700	M20 15.06.16 R	R	∅ 3-100	15x6x10/6	16	16	0.3
01290800	M20 15.06.16 L	L	∅ 3-100	15x6x10/6	16	16	0.3

Repuesto Spare Part	
Código Code	Referencia Reference
01983220	EAM20/M21

